

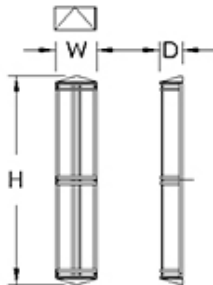

DIMENSIONS



W	H	D	MC	BASE MODEL NO.
7 1/4"	38"	4"	19"	S9322-L48
7 1/4"	50"	4"	25"	S9323-L64

SPECIFICATIONS

Driver: 0-10V dimming to 1%, 120/277

Mounting: Mounts to all Standard Electrical Junction Boxes (by others) With Hardware Provided. Silicone Seal Required (by others).

FEATURES

- Opal Acrylic Lens
- Solid Aluminum Bar Stock Material
- Solid Aluminum End-Caps
- UL Listed for Wet Location
- LED 0-10V Dimming Driver

ORDER AS A COMPLETE UNIT:

Model No. + Lamp Code + CCT + Finish + Option Code

S9322-L48	+	27K	+	PT	+	Option
S9323-L64		30K		SD		
		35K		XT		
		40K				

FINISHES

PT Powder Coated Finishes*

SD Shimmer Dimensional Metallic Finishes*

XT Trending Brushed Metal Finishes*

*(Specify Color Code from the list of Finishes [except interior only metallics] – ie. Gold Touch would be 'GT')

OPTIONS

BAC Buy America; Buy American Act; and Build America, Buy America Act Compliant.

EML Remote 10W Emergency LED Battery Backup

LIGHT OUTPUT

LXX = ~ 75 LPW Delivered Lumens (Example: L48= 48W x 75LPW = 3,600 Lumens)